

**NOTE**  
See DTM 1509 006 For Northern Diversion Route

**NOTE**  
See DTM 1509 004 For Two Way Lights Installation Plan

**KEY**

- Cone
- Sign
- Northern Diversion Route
- Southern Diversion Route

**Sign Count** 59

**Southern Diversion Route**  
**Clockwise Diversion**

Station Road / Meldreth Road / Frog End / Royston Road

**Anti-Clockwise Diversion**

Royston Road / Frog End / Meldreth Road / Station Road

Min width of sideways safety zone (S)	1.2 m	1.2 m
Min length of longways clearance (L)	30 m	60 m
Speed of the road	<span style="border: 1px solid black; border-radius: 50%; padding: 2px;">50</span>	<span style="border: 1px solid black; border-radius: 50%; padding: 2px;">/</span>

Rev	Description	By	Chk	Date
Revisions				



Project:  
A10 Royston Road,  
Cambridge, SG8 6QT  
Grid Ref: (x)539997 ; (y)247491

Title:  
Temporary Two Way Lights  
And Road Closure And  
Diversion

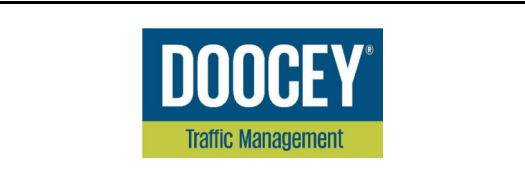

Design: ACW	Drawn: ACW	Chkd: RB
Date: 05/11/20	Date: 05/11/20	Date: 05/11/20
Scale: A3 - NTS	Status: Proposed	
Drawing No	DTM1509 - 005	
	Rev:	-

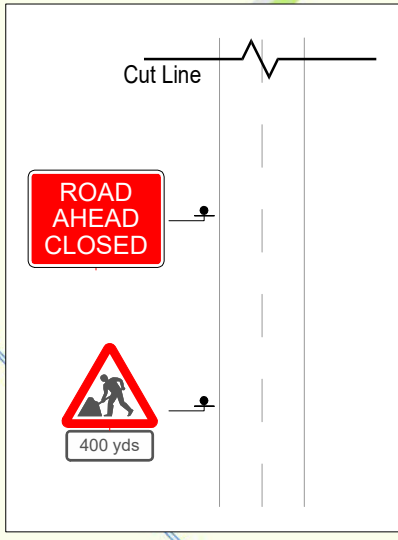

Fowlmere Road  
CLOSED Ahead  
For Access  
Please Follow  
Diversion  
Via Frog End